

Product

Echo™ Qualified 384-Well COC ADE Source Microplate, Low Dead Volume

Features

Echo qualified source plates are required for reliable dispensing with Echo liquid handlers. These plates have been designed and tested for optimal performance in ADE and our software has been developed to ensure the reliable dispensing with these plates. Labcyte researchers have more than 100 years of combined experience in acoustic physics and have applied this unique and diverse knowledge to development of these source plates.

Flat-bottomed plates designed for acoustic droplet ejection (ADE) technology on the Echo™ liquid handlers. Recommended working volume of 2.5-12 µL.

Conforms to SBS microplate standards for footprint and dimensions, 127.76 mm x 85.48 mm x 10.4 mm.

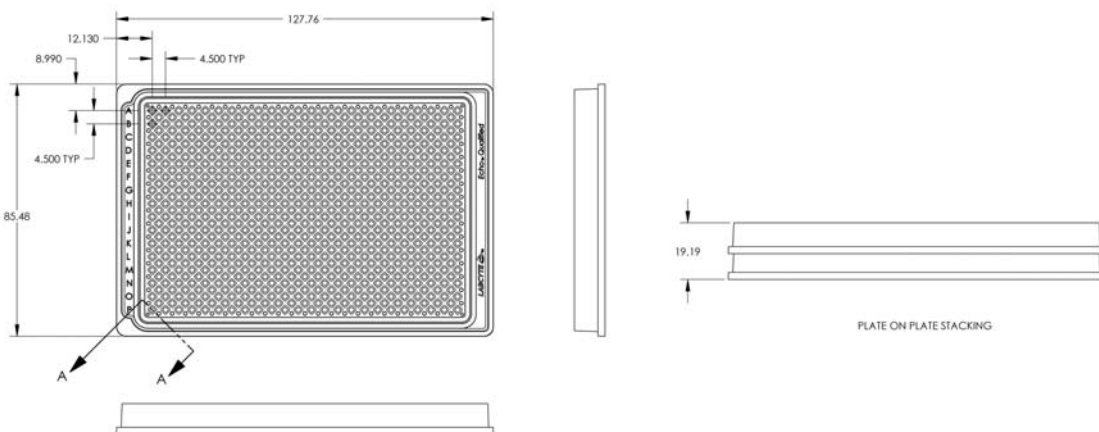

Specifications

- Item #:** LP-0200
- Composition:** COC
- Format:** 384-Well
- Color:** Clear
- Well bottom:** Flat
- Well shape:** Diamond
- Well diameter, top/bottom:** 2.43/1.53 mm
- Well A1 column offset:** 12.13 mm
- Well A1 row offset:** 8.99 mm
- Pitch:** 4.5 mm
- Working range:** 2.5-12 µL
- Lids available:** Yes
- Lids included:** No
- Bar code labeling:** Available
- Sterile:** No
- Echo source plate insert:** 4.5 mm
- Heat seal compatible:** Yes
- Qty/Case:** 50 plates/case
- Qty/Package:** 10 plates/package

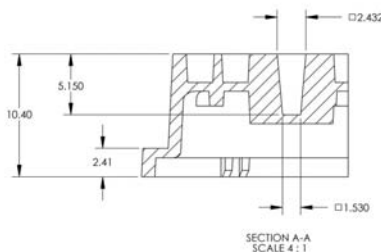

*dimensions are in mm

